

Exterior Wall Footing Example

ABBREVIATIONS

PRESS. = PRESSURE TREATED

O.C. = ON CENTER

W/N = WITHIN

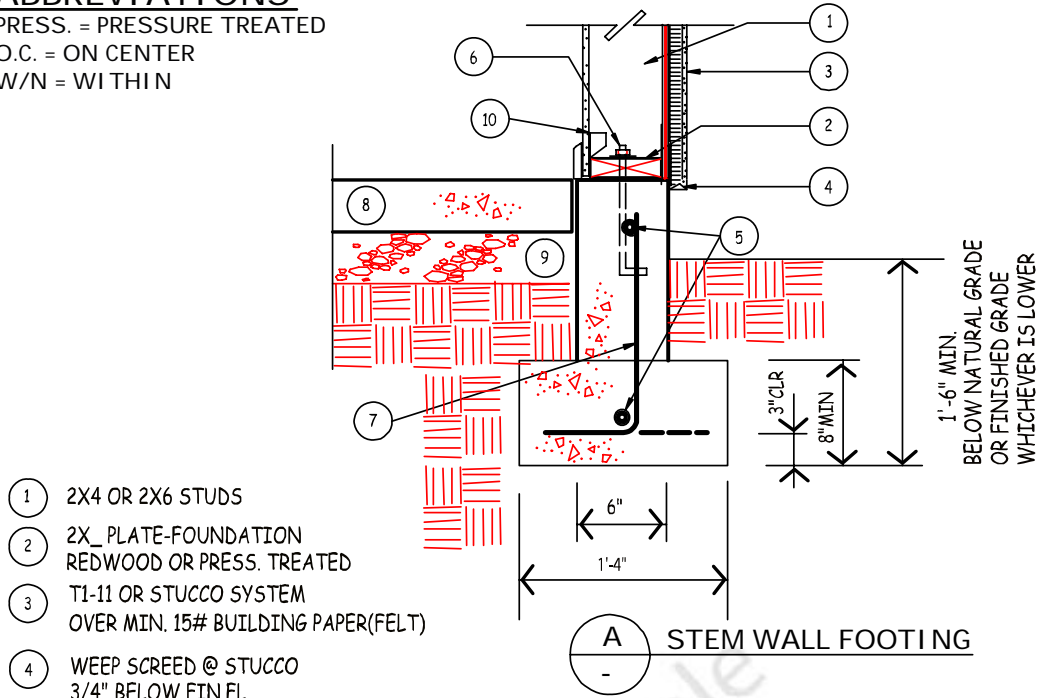

- ① 2X4 OR 2X6 STUDS
- ② 2X PLATE-FOUNDATION
REDWOOD OR PRESS. TREATED
- ③ T1-11 OR STUCCO SYSTEM
OVER MIN. 15# BUILDING PAPER(FELT)
- ④ WEEP SCREED @ STUCCO
3/4" BELOW FIN.FL.
- ⑤ #4 CONT. TOP & BOT.
- ⑥ 1/2"X10" ANCHOR BOLT, 7" MIN. EMBED.
@ 48" O.C. & W/N 12" OF PLATE ENDS
- ⑦ #4 @48" O.C.
ALT. BEND
- ⑧ 2500 PSI CONCRETE
- ⑨ 4" COMPACTED ABC
- ⑩ H2.5 ALT. STUDS

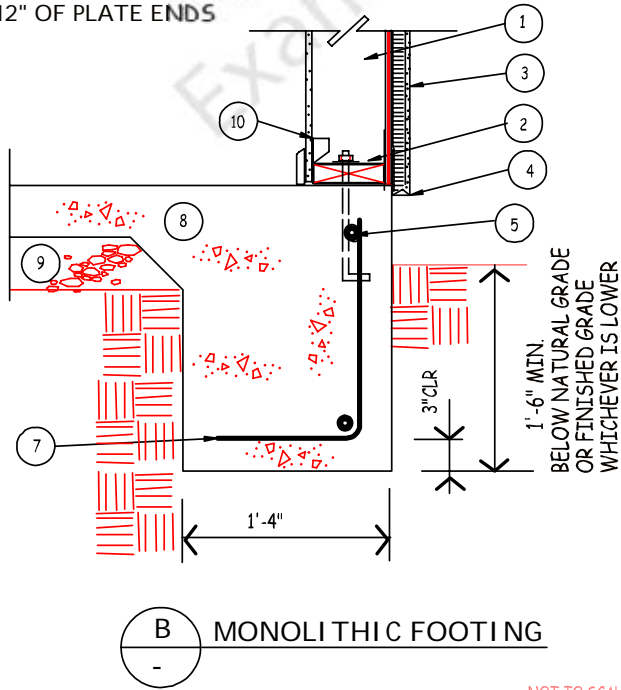

NOT TO SCALE

Figure is for example purposes only.